

***Krishna-Avanti Primary School  
Public Exhibition***

2006

# *Backdrop*

---

## *A once in a lifetime opportunity to create a landmark education project... ..*

- I-Foundation is promoting the proposed Krishna-Avanti Primary School in Harrow – the first Hindu Voluntary Aided school in the country.
- I-Foundation has commenced a consultation process with a view to publishing a Statutory Notice by the end of September 2006
- The School will be established as a one-form entry mixed primary school with attached nursery. 8 year groups - Reception to Year 7 inclusive
- There will be 52 Nursery places, 26 morning, 26 afternoon. There will also be accompanying childcare facilities
- The principle of a Hindu school has been approved - this is NOT site specific:
  1. Cross Party Support from Harrow Council
  2. The Department for Education and Skills (DfES)
- The School aims to be a centre of excellence with the highest possible standards of academic, moral and spiritual education delivery
- I-Foundation are considering William Ellis Sports ground as a possible site for the School

# *Why a Hindu School? Why Harrow?*

---

- Parental choice
- Grassroots demand
- 6,400 primary faith schools in UK. Vast majority are Christian, with 36 Jewish, 7 Muslim and 2 Sikh schools
- Harrow has the highest Hindu population of any borough in UK
- Educational excellence in Harrow
- Surplus places in Harrow are an issue and thus the School will:
  - be one-form entry though demand would merit two-form
  - open incrementally

# *Hindu School Vision Statement*

---

*Where lessons are learnt for a lifetime...*

*The School will develop each child's full potential **spiritually, morally and academically**, preparing students to become individuals of good **character, behaviour and competence** integrated within contemporary British society*

# *Values*

---

*The School aims to provide an environment for:*

- A healthy body and mind
- Character building and social skills
- Engaging with parents and the community
- Appreciating nature and the environment
- Exceptional academic delivery and achievement

# *School Aims*

---

- To create a flagship institution that will deliver best-in-class academic education whilst fostering attraction to the values, philosophy and practices of Hinduism
- To create in the children an understanding of how to apply Hindu scriptures in their daily lives
- To provide the children with a unique opportunity to engage their creativity through the medium of devotional art, music, dance and drama
- To encourage children to be sensitive towards all living beings, other religions and cultures and to the society and environment they are part of
- To help the children gain self-esteem, self-confidence and integrity within themselves through self-discipline based on an understanding that they are a servant of God

# *Curriculum & Educational Programme*

---

- Teach the National Curriculum
- Teach a curriculum that is broad, balanced and well planned and which will include Performing Arts, Modern Languages, PE and Educational visits
- Inclusiveness and multicultural ethos
  - integrate with other LEA schools
  - working within local Cluster groups
  - broader community agenda
  - other faiths and local community groups
- Ensure a smooth transition to secondary education
  - pupils are prepared emotionally & academically
- Implement a comprehensive pastoral care system
- Equal opportunity to boys and girls
- Cater to SEN children to help them reach their full potential

# *Governance*

---

- I-Foundation will nominate the majority of Governors onto a newly formed charity that will form the School's governing body.
- The remaining Governors will be drawn from representatives of the LEA, parents and school staff as per statutory requirements.
- The governing body will fulfil a largely strategic role in the running of the school.
- The governing body will adopt a code of conduct to which every governor agrees to adhere to.
- ISKCON (the International Society for Krishna Consciousness) is the official Faith Partner.



# Designs from the exhibition

## NEW HINDU PRIMARY SCHOOL PRELIMINARY PROPOSALS WILLIAM ELLIS SPORTS GROUND



EXISTING SITE



PROPOSED SITE - THE PROPOSED SCHOOL OCCUPIES UP TO HALF OF THE SITE



CONSULTATIONS

# Designs from the exhibition

---



SKETCH SHOWING HOW THE SCHOOL MIGHT LOOK

NEW HINDU PRIMARY SCHOOL  
PRELIMINARY PROPOSALS



DEVELOPMENT MODEL LOOKING AT OPTIONS FOR THE THE SCHOOL

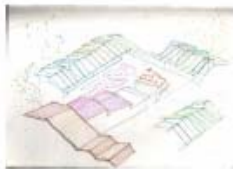

DEVELOPMENT SKETCHES MODELS AND COLLAGES SHOWING HOW THE DESIGN WILL BE DEVELOPED

